

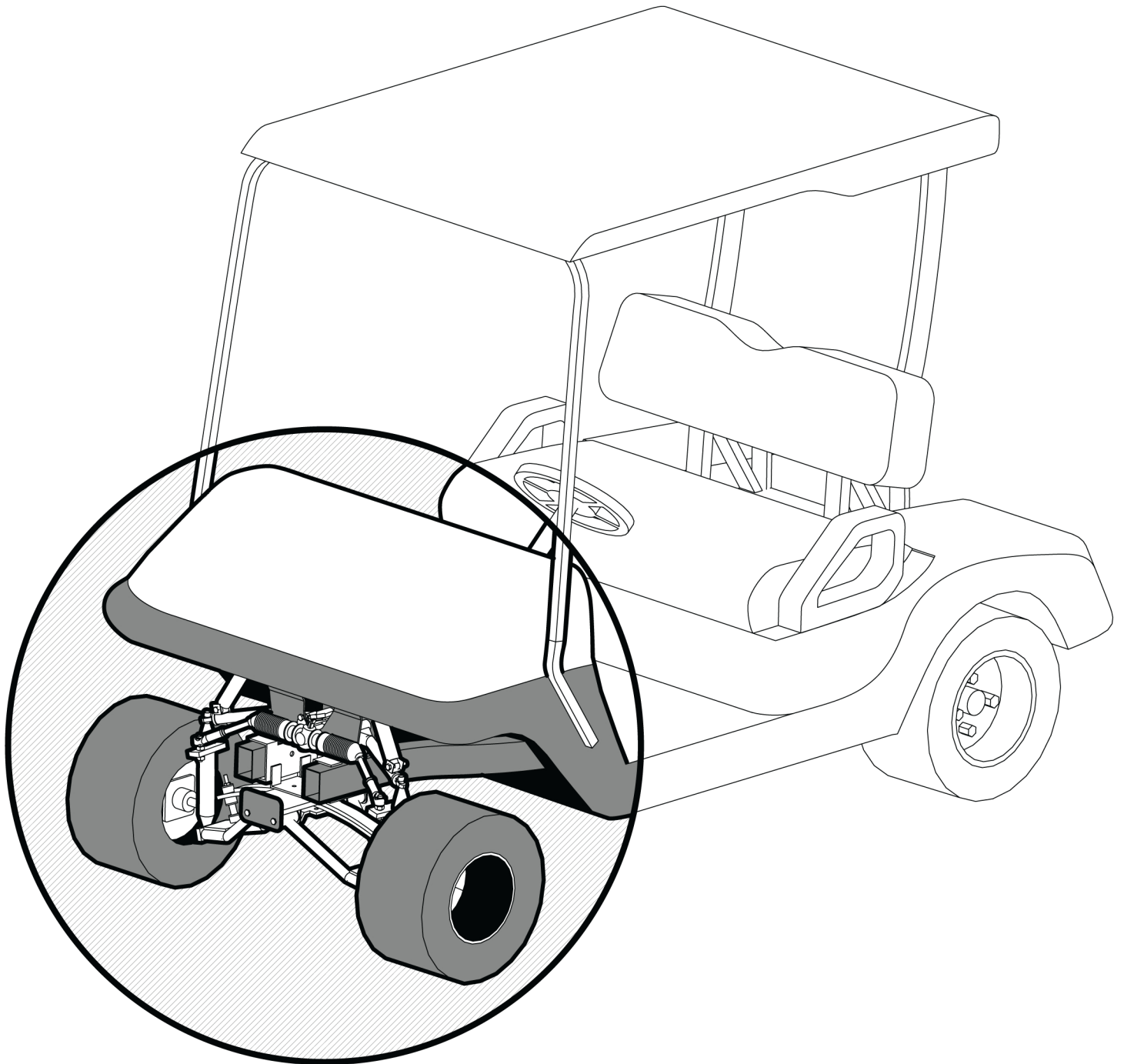

Precedent

4" & 6" A-Arm Lift Kit

instruction manual



Parts List

Front Suspension

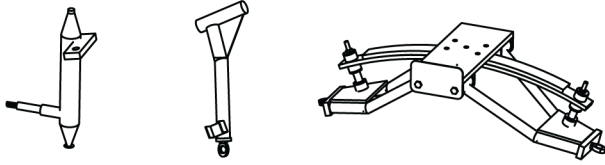

Spindle Body (2) Control Arm (2) A-Arm Assembly

Rear Suspension

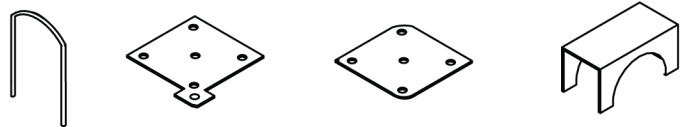

U-Bolt (4) 6-hole Shock Plate (2) 5-hole Bottom Plate (2) Axle Seat (2)

Nuts & Bolts

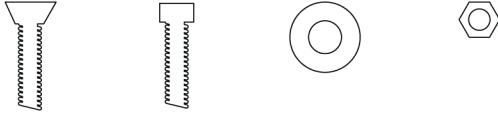

Patch Bolt [1/4" head] 1/2" x 1-1/2" (4)
Hex head Bolt 10mm x 40mm (4)
3/8" Washer (8)
3/8" Nyloc Nut (8)

Installation

Front end disassembly

1. Raise cart and support frame.

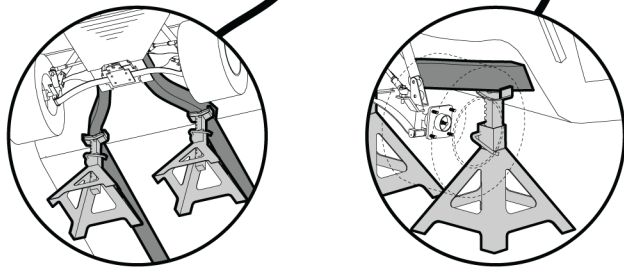
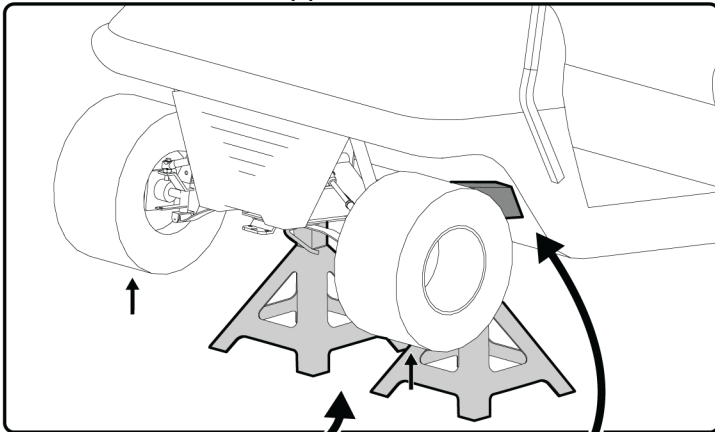

support front frame rails with jack stands and raise until front wheels clear the ground.

2. Remove front bumper.

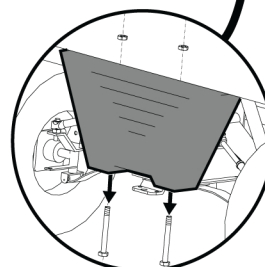
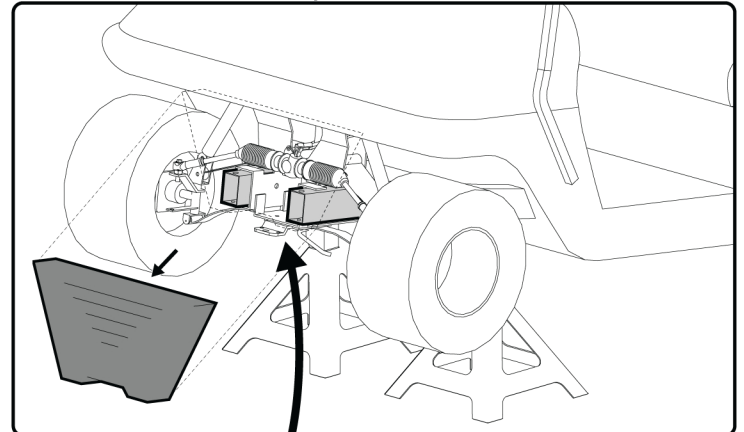

Remove nuts(2) and bolts(2) connecting front bumper to underside of frame rails.

Installation

Front end disassembly

3. Remove wheels.

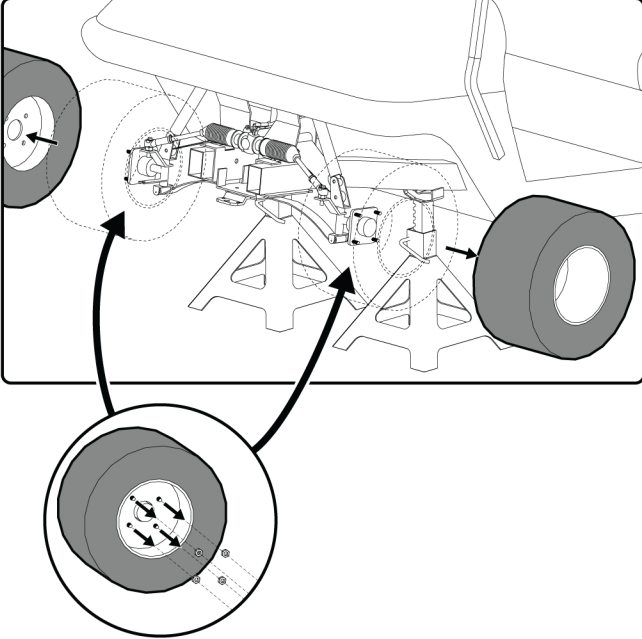

Remove nuts(4) connecting wheels to wheel hubs and set aside wheels.

4. Remove wheel hubs.

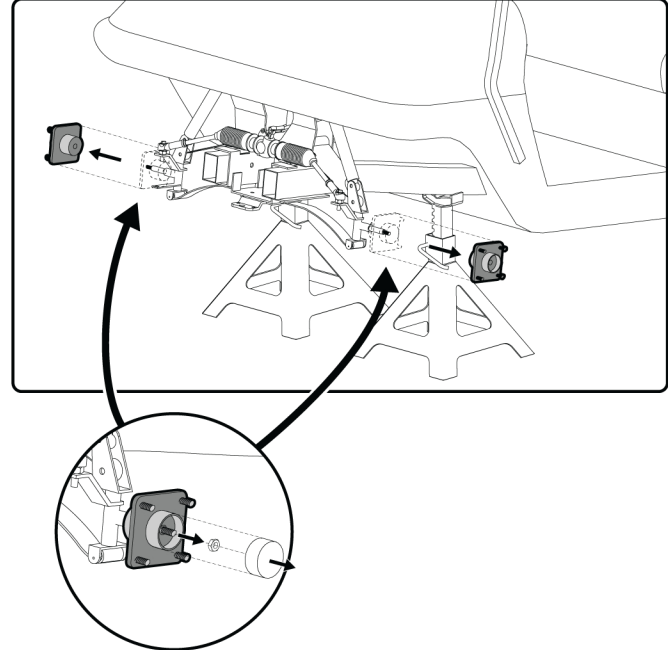

Remove dust cap cover and nut connecting wheel hubs to spindles. Set aside wheel hubs.

5. Remove steering assembly.

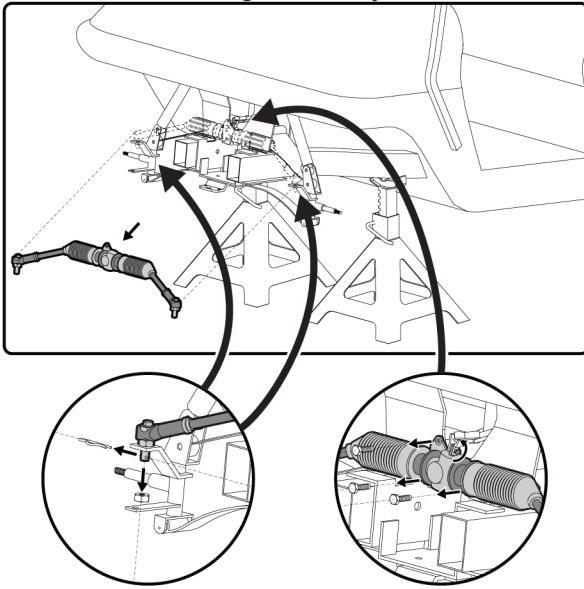

Remove cotter pin and nut connecting tie rods to spindle body.

Remove bolts(3) connecting steering assembly to frame plate. Loosen bolt holding assembly to intermediate shaft.

6. Remove leaf spring/control arm assembly.

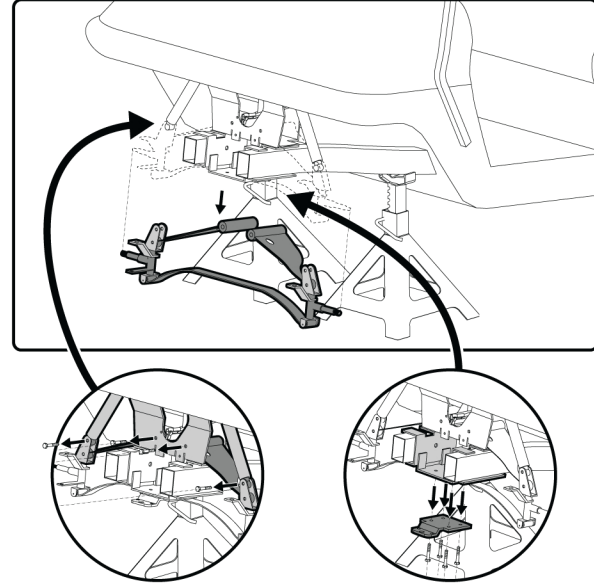

Remove bolts(4) connecting control arms to frame plate and shocks to spindle body.

remove bolts(4) connecting lower bracket to rail plate.

Front end assembly

1. Install A-arm assembly.

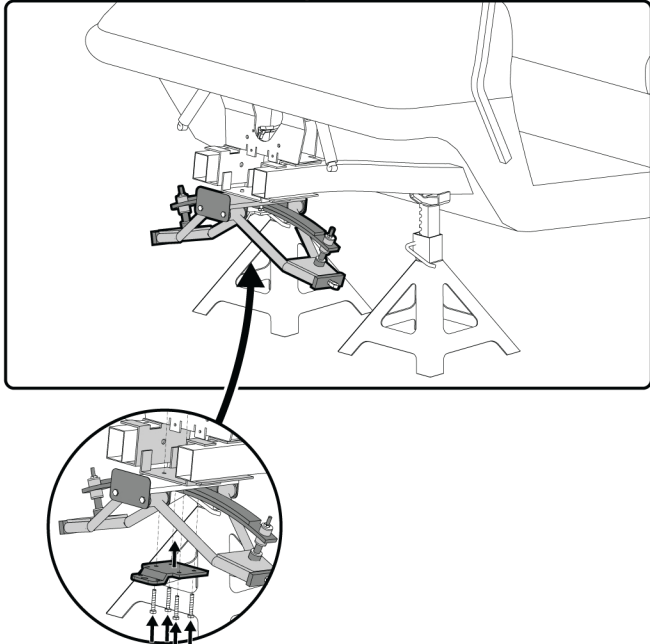

Connect a-arm assembly to frame plate using factory tow plate with supplied hex head bolts.

2. Install upper control arms.

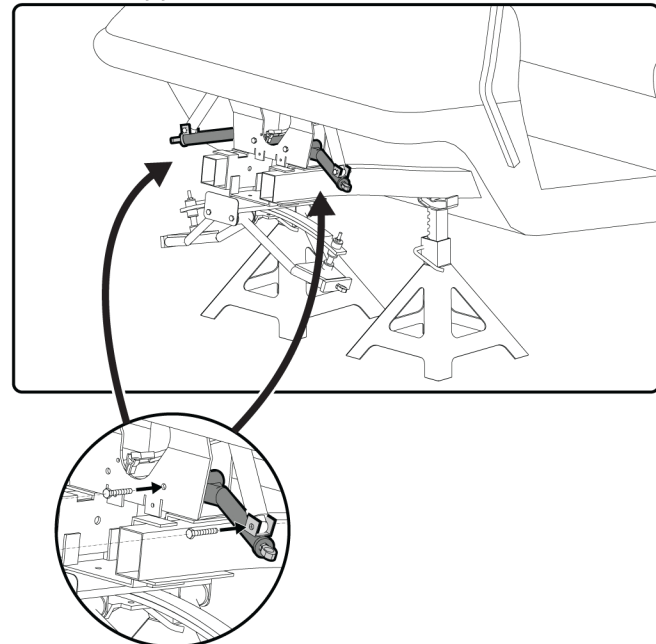

Connect upper control arms to lower shocks and frame plates using supplied bolts.

Installation

Front end assembly

3. Re-install steering assembly.

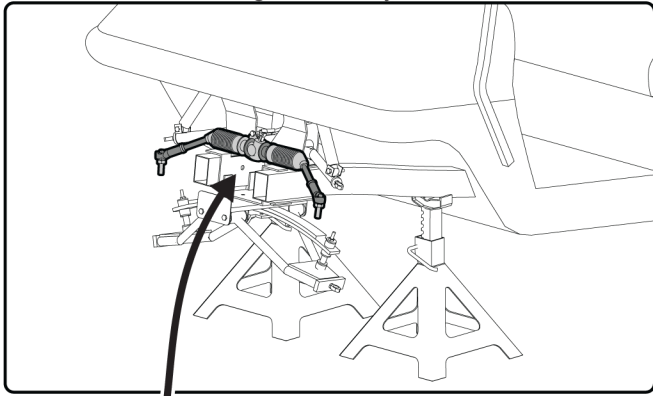

Connect upper control arms to lower shocks and frame plates using supplied bolts.

4. Install spindle bodies.

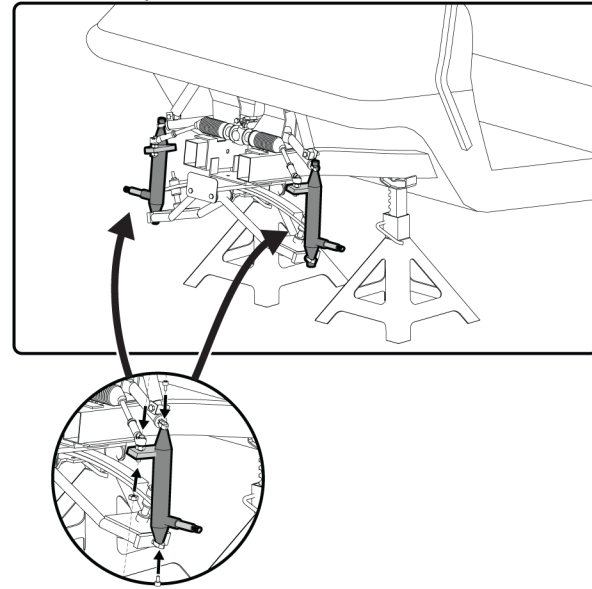

Connect spindle bodies to a-arm assembly and control arm through ball joints with supplied patch bolts. Connect tie rod ends with factory nuts.

5. Re-install wheel hubs.

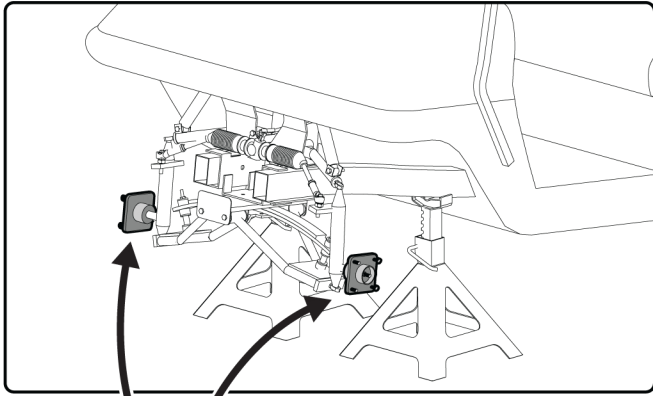

Connect factory wheel hubs to spindle bodies using factory nuts and dust covers.

6. Re-install wheels.

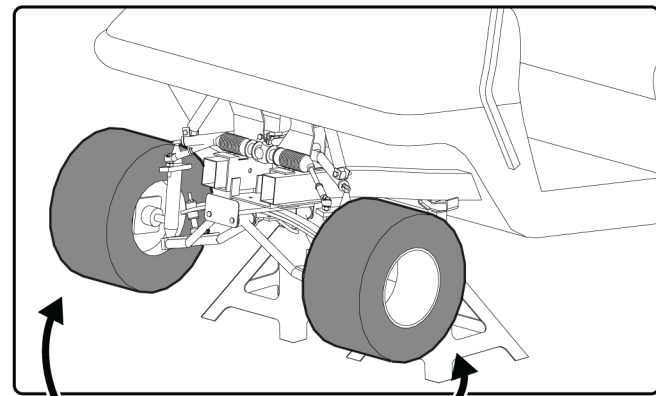

Connect wheels to wheel hubs using original nuts. Lower cart and remove jack stands

Rear end assembly

1. Raise rear end and support frame.

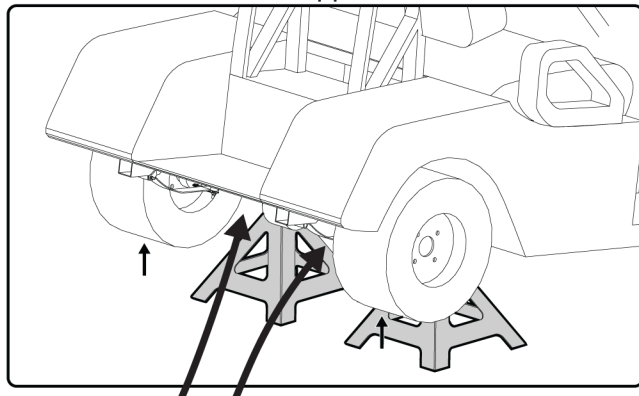

Support frame rails with jack stands and raise until rear wheels are clear of the ground.

2. Disconnect shocks and cables.

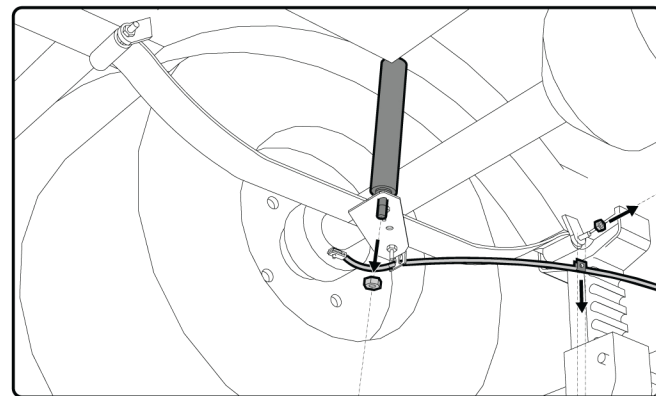

Remove bolt connecting shock to factory shock-plate. Remove bolt connecting brake cable clip to frame.

Installation

Rear end assembly

3. Remove U-bolt and shock plate.

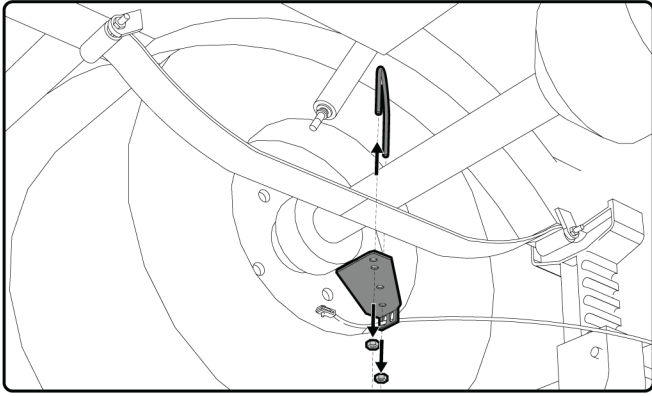

Remove nuts connecting u-bolt to shock mount plate, and remove u-bolt and shock mount plate. **DO NOT** remove brake cable from shock plate.

4. Raise axle and remove leaf spring.

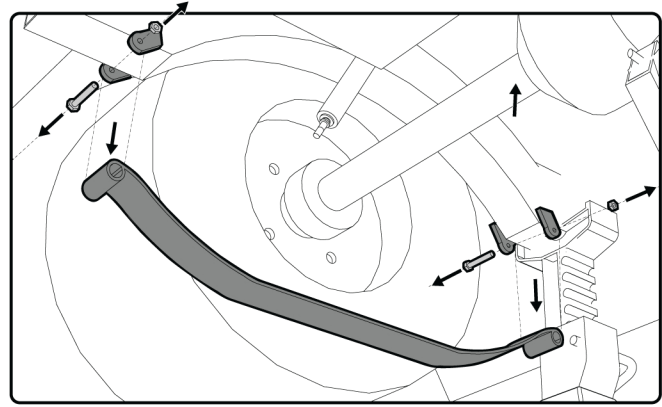

Use a floor jack to raise axle off of leaf spring. Remove bolts connecting leaf springs to frame rails. Remove leaf spring.

5. Lower axle and re-install leaf spring.

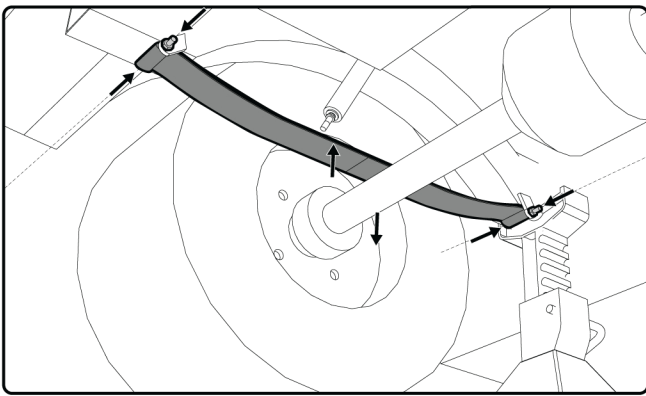

Lower axle on floor jack. Re-bolt leaf spring to frame, positioned above the axle.

6. Install U-Bolt and Plate Assembly.

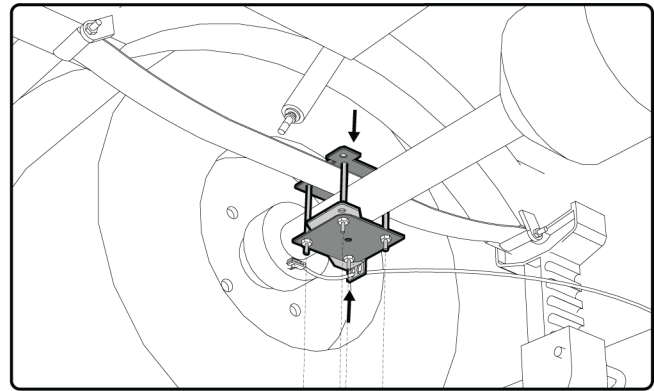

Install new U-bolts(2) and new 6-hole shock mount plate on top of leaf spring. Install original shock mount/brake cable plate and new bottom 5-hole plate onto U-bolts. Start nuts on U-bolts, but **DO NOT** tighten until next step.

7. Install Axle Seat.

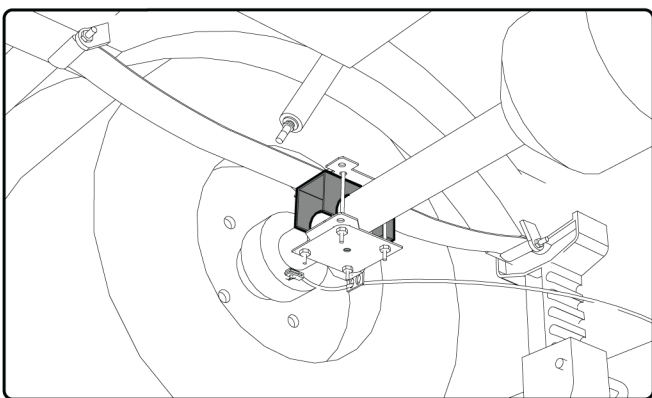

Install axle seat between axle and leaf spring and tighten u-bolt nuts to secure assembly. Repeat steps 2 - 7 for the opposite side of the axle.

8. Attach shocks to new shock mount.

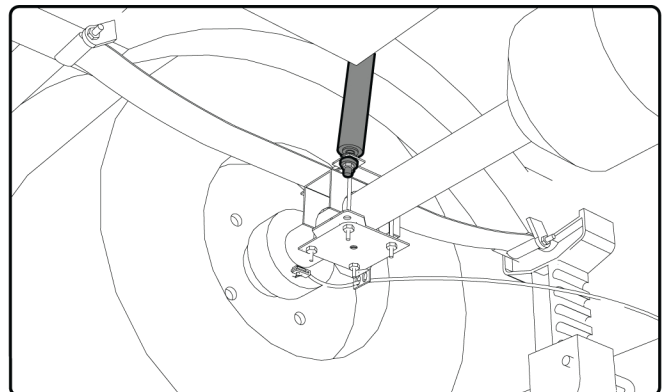

AFTER repeating steps 2 - 7 for both sides of the axle, re-attach shocks to new shock mount plates. Lower cart and enjoy!